



# USER GUIDE

Staff Room Products

LC SCS136W

LC SRS149W

LC SRS236W

LC SRS115W

## BEFORE USE

The installation of this appliance is best carried out by 2 people.

- Dispose of all packaging carefully and responsibly.
- The appliance is designed for indoor use only and must be protected from rain, moisture and extreme temperature variations.
- The appliance **MUST** be positioned on a firm level base. Do not splash water on the appliance. It may cause electrical parts to fail and result in an electric shock.
- Leave the appliance in its intended place of installation and in its correct orientation for at least 4 hours before switching on to allow the cooling system to settle before first use or after any transportation.
- Your appliance is an environmental friendly product and it contains non CFC / HFC gas substances in the cooling system (Called R600a) and in the insulation (Called cyclopentane) which are potentially flammable if exposed to fire. Therefore, take care not to damage, the cooling circuit / pipes of the appliance in transportation and in use. In case of damage do not expose the appliance to fire, potential ignition source and immediately ventilate the room where the appliance is situated.
- Do not sit, stand or place any other heavy objects on top of the appliance. This could result in injury or damage to the appliance.
- Keep ventilation opening, in the appliance enclosure or in the built-in structure, clear of obstruction.

## SAFETY

### Disposal of old appliances

Remove any plugs and power leads to ensure that the appliance is inoperative.



**Please note:** This symbol means that products bearing it may not be disposed of with household waste.

The refrigeration system contains insulating gases and refrigerant which will require specialist disposal. Most components can be recycled. Always contact your local council or authority for information regarding the correct disposal/removal of old appliances, do not dispose of with household waste.

**WARNING:** When disposing of an old appliance make sure that the pipe work does not become damaged.

### Packaging

All of the packaging supplied with your appliance can be recycled, or disposed of without any harm to the environment.

Cardboard may be crushed, or cut into smaller pieces if required for recycling or disposal. The polythene and polystyrene included contain no CFC's, and are environmentally friendly.

For further information on recycling, contact your local council or authority.

- Before installing and using your new appliance. Read through the instructions supplied with your appliance - failure to install or use this appliance in accordance with the instruction book may invalidate any warranty.
- The manufacturer does not accept any liability for damage caused through improper use, or incorrect installation.
- Do not install this appliance if it has been damaged during transportation. This includes the plug and power supply cord.
- Always install this appliance in line with these instructions.
- Always read these instructions fully before using the appliance for the first time.

## WARNING:

- Do not allow the refrigerant circuit to become damaged while using or installing. Should it become damaged, do not use the appliance until you are instructed to do so by a service engineer [Refrigerant can ignite or cause damage to the eye when leaking]
- Always remember to unplug the appliance before cleaning. When disconnecting from the electricity supply, pull the plug, not the power cord.
- Do not use any electrical appliance inside the food storage area - unless they are recommended by the manufacturer.
- All electrical repairs must be carried out by a qualified electrician. Inadequate repairs may result in a major source of danger for the user and invalidate any warranty.
- Never store anything dangerous inside the appliance, such as combustibles, explosives, strong acid and alkali etc.

## SAFETY

- Never store alcohol in a freezer
- Do not store liquids in glass containers in the freezer compartment as these may shatter.
- Always keep any ventilation openings clear of obstruction. Should they become blocked, clear them straight away.
- Make sure that the plug is in an accessible place when installation is complete and remove all packaging.
- Refrigerating appliances might not operate consistently when sited for an extended period of time below the cold end of the range of temperatures of the appliance.
- Do not store explosive substances.
- Do not use mechanical, electrical or chemical way to speed up the defrost process not recommended by the manufacturer.
- Do not use or place other electrical products inside the appliance not recommended by the manufacturer.
- In case there is an inflammable gas leaking, open the window for air circulation and do not pull out the plug or turn the temperature knob. Do not touch the appliance until the valve of gas is turned off. Otherwise, sparks may happen.
- Do not attempt to repair the appliance yourself. Contact contact a qualified service engineer.
- When defrosting the appliance, never use sharp or pointed metal implements. Always use a plastic scraper. (see Defrosting for more information)
- Do not damage the refrigerant circuit
- When positioning the appliance ensure the supply cord is not trapped or damaged.
- Do not locate extension sockets or charging transformers/power supplies adjacent to the compressor as they could overheat.

## ABOUT YOUR PRODUCT

### LC SRS115W

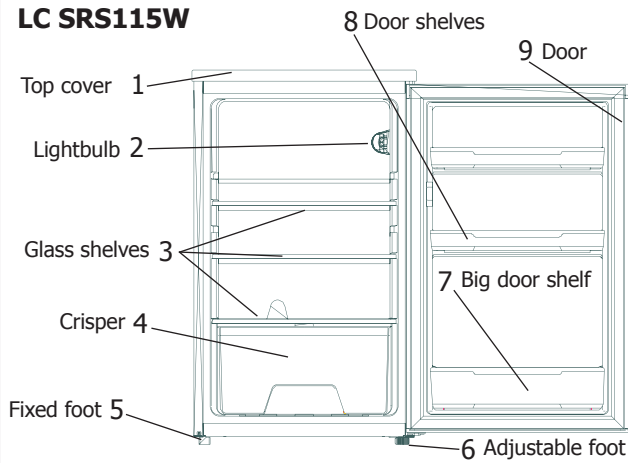

### LC SRS236W

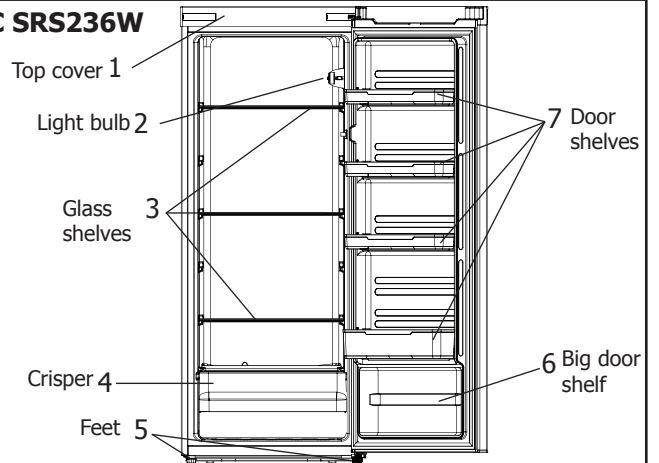

### LC SRS136W

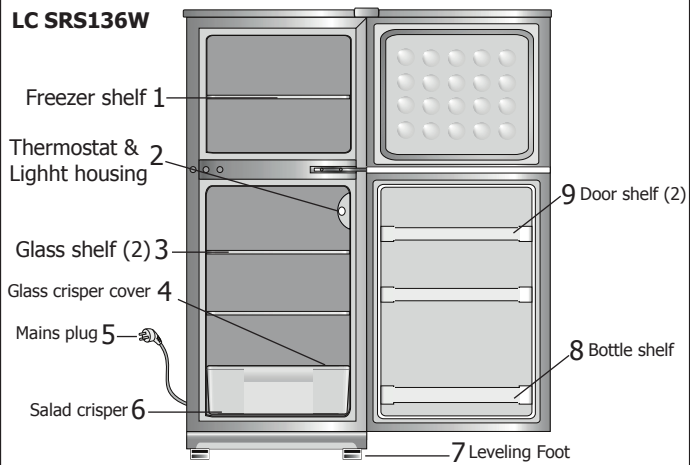

### LC SRS149W

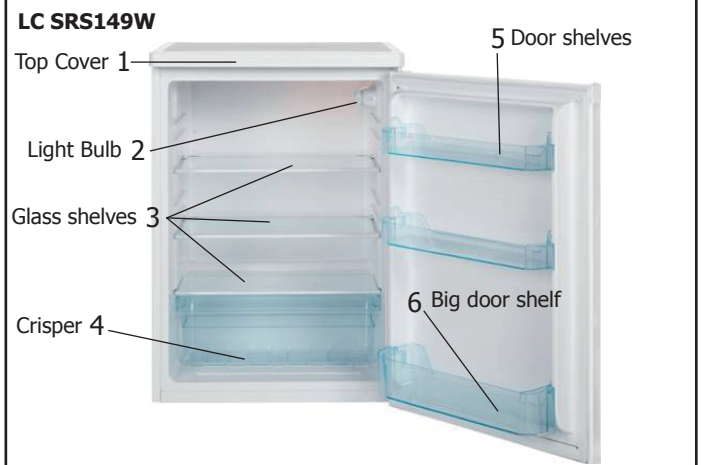

## ABOUT YOUR PRODUCT

Technical Specificaion				
Model Description	LC SRS115W	LC SRS236W	LC SRS136W	LC SCS149W
Unit External Width (mm)	501	550	475	600
Unit External Depth (mm)	540	550	573 (w/handle) 550 (w/o handle)	600
Unit External Height (mm)	845	1420	1246	850
Fridge Gross Capacity (litres)	115	236	100	149
Fridge Net Capacity (litres)	112	235	97	147
Freezer Gross Capacity (litres)	N/A	N/A	36	N/A
Freezer Net Capacity (litres)	N/A	N/A	35	N/A
Climate Class (if applicable)	4	4	4	4
Refrigerant Type	R600a	R600a	R600a	R600a
Refrigerant Mass (g)	18	20	27	35

This appliance operates at a voltage of: 220 - 240V ~ 50Hz

This appliance is rated Climate Class 4 as defined in BS EN ISO 23953-2:2005

Climate class 4 operates in a climate up to 30°C and 55% humidity

## INSTALLING YOUR APPLIANCE

### Before you start

- This appliance must stand vertically on a flat, even surface, to level the appliance, use the levelling feet by turning them until the appliance is as level as possible. Do not install onto carpeted surfaces as this prevents adequate ventilation.
- Install the appliance in a well ventilated room. The appliance should not be placed near any heat sources (cookers, heaters etc.) or in any unheated rooms as the ambient temperature affects the performance of the appliance.
- Do not lift the appliance by the pipes or the door when moving. Should the appliance become damaged, contact Lec Customer Care and do not use the appliance until you are instructed to do so by a service engineer.

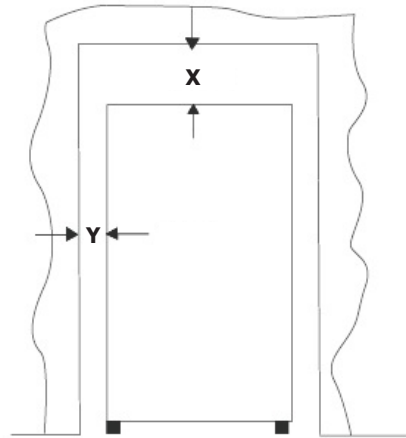

LC SRS148W - X: 300mm Y: 100mm

LC SRS236W - X: 100mm Y: 25mm

LC SRS115W - X: 25mm Y: 25mm

### Installation Clearances

- Allow 300 mm clearance at the rear of the appliance and adequate clearance on each side of the appliance and over the top to ensure proper ventilation (see figures).

### Getting Started

Once you have installed your appliance in an appropriate location, follow the start up procedure below:

- Before you plug in the appliance, clean thoroughly the inside, and any accessories with warm water and bicarbonate of soda (0.5ml to 0.5 litres) and dry with a soft cloth.
- Leave the appliance to stand for 2 - 3 hours to allow the refrigerant to settle following installation and cleaning. If the appliance has been transported horizontally, it must be left to stand vertically for 12 hours before installation.
- Once dry, plug the appliance into the socket
- Turn the thermostat to the required setting - a medium setting is usually suitable.
- Leave the appliance for at least 4 hours before storing any food inside to allow a sufficient temperature to be reached.

## INSTALLING YOUR APPLIANCE

**Caution:** 2 people are required to unpack and handle the appliance, it is recommended that gloves are worn.

- The appliance should be transported only in an upright position. Do not tilt the appliance greater than 45°. The packaging as supplied must be intact during transportation.
- After transporting the appliance, leave it for at least 4 hours before switching on to allow the cooling system to settle. Failure to comply could result in damage to the appliance.
- Do not move the appliance by pulling the door or handle as it may damage your flooring and wall coverings etc.
- Empty any water in the drain tray before moving.
- Make sure that the defrost water pipe at the back of the product is fixed to the plastic evaporating pan on the top of the compressor, to avoid defrost water spillage on the floor.
- Ensure the supply cable is not caught under the appliance during and after moving.
- Carefully remove all packaging materials including the foam base, dispose of correctly.
- Make sure that the sufficient room is provided around the appliance to ensure free air circulation
- Screw in the two spacers (where applicable) at the back of the appliance.
- Do not place the appliance near a heat source or in direct sunlight.
- Do not put any heavy objects on top of the appliance. It will damage the appliance.
- Do not install the appliance in moist and wet place.
- Adjust the feet at front to level the appliance. It should be installed on a smooth surface to avoid excessive vibration and noise.
- Each appliance has a climate class (shown on the rating plate) where it indicates the temperature range of the appliance operation in place. The appliance may not work properly if it is left for a long period at a temperature outside the specified

range.

- Refer to section "Care and Maintenance" to prepare your appliance for use.

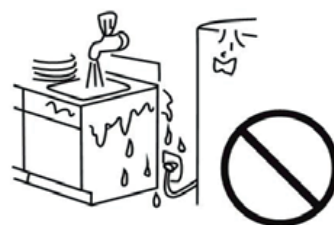
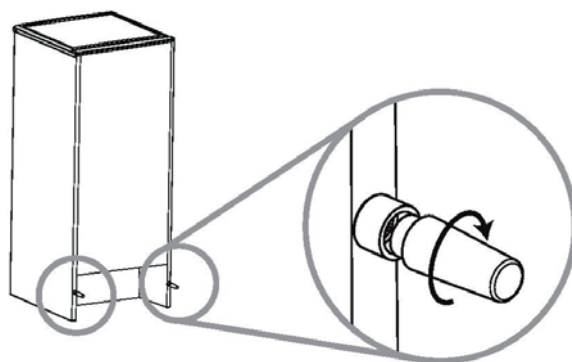
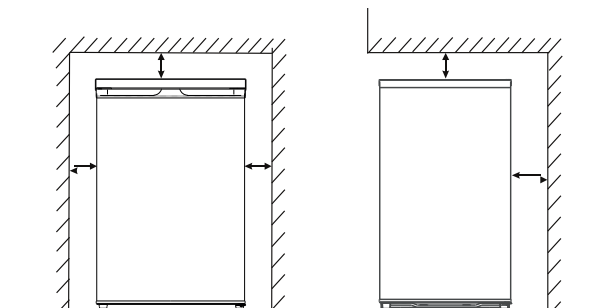



## USING YOUR APPLIANCE

### About the thermostat

The thermostat is located in the upper right part of the appliance.

- To reduce the temperature inside the appliance, turn the thermostat towards the highest.
- To increase the temperature inside the appliance, turn the thermostat towards 1 minimum.
- Depending on the ambient temperature of the room the appliance is in, you may need to adjust the thermostat accordingly.

CONDITION / REASON	SETTING ADJUSTMENT
<b>Refrigeration too cold</b> - Not set correctly for your conditions	Adjust TEMPERATURE Control one setting lower
<b>Refrigeration too warm</b> - Door opened often, large amount of food added or room temperature very warm	Adjust TEMPERATURE Control one setting higher
<b>Freezer too cold</b> - Not set correctly for your conditions	Adjust TEMPERATURE Control one setting lower
<b>Freezer too warm / too little ice</b> - Door opened often, large amount of food added or room temperature very cold (can't cycle often enough) or heavy ice usage	Adjust TEMPERATURE Control one setting higher

### Tips for using this appliance

- Before storing cooked foods in the refrigerator, allow them to cool to room temperature.
- To maintain adequate air circulation, do not over fill the appliance. If there is too much food inside, the compressor does not work as effectively.
- Do not open the door any more than necessary- this will keep the temperature as cold as possible inside.
- Ices and water ices should not be con-

sumed straight from the freezer - this can cause ice burns to the tongue and hands.

- Never touch the inside of the appliance, or any frozen items with wet hands. This can cause injury to your hands if they stick to cold surfaces.
- Wrap or cover foods well before storing. Always make sure that any packaging is air tight and suitable for use inside a fridge or freezer.
- Cooked meats and raw meats should be stored on separate shelves, and raw meat should not be allowed to drip onto other foods. Should not be in direct contact with already frozen food.
- You may hear gurgling noises or a humming sound while the appliance is in use and this is perfectly normal when the compressor is running and the coolant is moving through the system.
- A clicking sound may be heard, this is the thermostat and is normal.
- Effervescent (fizzy) drinks should not be stored in the freezer or low temperature compartments.
- Do not exceed the storage times recommended by the food manufacturer and always check expiry dates.
- Do not wash shelf retention in hot water.

### The drainage channel

The drainage channel collects water on the back wall of the refrigerator and ensures that it is drained away into a drip tray at the rear of the appliance.

## USING YOUR APPLIANCE

### Final checks before operating the appliance

1. Good air circulation around the appliance positioned.
2. The feet have been adjusted for perfect levelling.
3. Clean the compartment per recommendation in section "Care and Maintenance".
4. Plug in the appliance and interior light will come on when the door is open.

Important: The compressor starts up and in operation may produce some background noise and it is normal, this is not a defect.

### Storing fresh food

- Use the fridge compartment to store fresh food and drinks.
- Do not exceed the food capacity that the appliance able to handle.
- Do not put warm food to the appliance immediately as it may cause excessive cooling of the compartment.
- Set the temperature knob at medium position for storing fresh food.
- Do not mix already frozen food and fresh food.

The following guidelines and recommendations are suggested to obtain the best results and storage hygiene.

- Frequent door openings can cause internal temperature rise so the door shall be closed as soon as possible after use.
- For hygiene reasons, it is always a good practise to pack, wrap and cover the food before storing.
- Use a polythene bag to store raw meat and place on the lowest shelf. Avoid contact with cooked food to prevent contamination. For safety reason, store raw meat for two to three days only.
- Cooked dishes must be stored in airtight covered containers.
- Food and beverages shall cool to room temperature before storing.
- Most vegetables should be blanched and chilled before freezing.
- Bottles can be placed in the door section.
- Some fruits and vegetables like pineapples, melons, tomatoes, and cucumbers

shall be wrapped in polythene bags.

- Do not leave frozen food at room temperature to thaw. You could defrost the food by putting it in the fridge to thaw slowly. Make sure you avoid defrosting food or food juices drip onto other food.

### Energy saving tips

- Cover all food stored, and arrange it so that cold air can circulate freely.
- Higher cold setting will use more energy. Do not set to maximum cold if it is not necessary.
- Cool the hot/warm food to room temperature before put them into your fridge.
- Frequently open and close door would cause internal temperature rise and it will consume more energy.
- Close the door(s) properly, and make sure the seals and hinges are airtight. Check the seals by putting a sheet of paper between the door and the main body of the fridge. If the paper moves, your seals need replacing.

We recommend a maximum weight of 10kg per shelf for storage of goods

## CARE & CLEANING

### Before cleaning your appliance

You should always unplug this appliance before cleaning.

### To clean your appliance

- Clean the inside of the cabinet with warm water and a neutral detergent, do not use harsh abrasives or caustic cleaners.
- Dry the inside of the cabinet with a soft, dry cloth. Always make sure the inside of the appliance is dry after cleaning.
- Avoid getting water into the electric components of the appliance (i.e. the thermostat), or spilling water on the fridge.
- When cleaning the door seals, use only warm soapy water. Please use a mild soap and avoid damaging the door seal as this will affect the performance of your appliance.
- Clean the outside of the appliance with warm, soapy water and dry with a soft cloth. Any accumulation of dirt and dust should be removed from the back and bottom of the appliance to maintain adequate ventilation.
- If the appliance is not in use for a long period of time, you should clean the appliance as detailed. Make sure that it is dry, then unplug and leave the door open to prevent unpleasant smells inside.

**Please note:** Regular turning off may shorten the life of this appliance.

**Important:** Always unplug the appliance from the power socket during cleaning and maintenance.

- Never use any sharp instruments or abrasive substances, soap, household cleaner, detergent or wax polish for cleaning.
- Use luke warm water to clean the cabinet of the appliance and wipe it dry.
- Never clean the appliance with flammable fluids. It could cause a damage and fire hazard.
- Clean the exterior of the appliance and door seal with a damp cloth and dry it through.
- Avoid water goes in the temperature control box. Clean with a dry cloth only.

- Clean the condenser (located at the back of the appliance) with a vacuum cleaner. It is suggested to remove the dust every year.
- Shelves are all removable for cleaning purpose.

### Light bulb replacement

Proceed the following to replace a failure bulb:

1. Switch off at the socket outlet and pull out the mains plug.
2. Remove the light diffuser cover by pulling the recess at the edge.
3. Replace the bulb with a new 10 watt (max) screw cap (SES) bulb.
4. Assemble the light diffuser cover and switch on.

## TROUBLESHOOTING

Before calling Lec Customer care, please check the table below to see if the problem can be solved without calling for a Service engineer.

Problem	Solution
The fridge / freezer doesn't work	<ul style="list-style-type: none"> <li>• Check that the appliance is switched on</li> <li>• Check that the plug is not damaged</li> <li>• Check that the fuse has not blown</li> <li>• Check that the voltage is correct for the appliance</li> <li>• Turn the thermostat up higher</li> </ul>
Unusual noises	<ul style="list-style-type: none"> <li>• Check that the appliance is on a flat, level surface and is stable.</li> <li>• Check that nothing is coming into contact with the appliance.</li> </ul>
The temperature inside the fridge / freezer is not cold enough.	<ul style="list-style-type: none"> <li>• Check that there is not too much stored in the appliance.</li> <li>• Check the frequency of door openings. If opened too often this can cause the compressor to run for some time.</li> <li>• Check that the thermostat is set to a suitable temperature.</li> <li>• Check that the appliance is not in direct sunlight, or near a heating source.</li> <li>• Check that the ventilation grille has not become blocked.</li> </ul>
The temperature inside the appliance is too cold	<ul style="list-style-type: none"> <li>• Change the temperature setting to a more suitable setting.</li> </ul>
The outer surfaces of the fridge / freezer are wet	<ul style="list-style-type: none"> <li>• Caused by condensation - dry the outer of the appliance carefully.</li> </ul>
The inner surfaces of the fridge / freezer are wet	<ul style="list-style-type: none"> <li>• The door is opened frequently, or kept open too long.</li> <li>• Caused by condensation - dry the inside of the appliance thoroughly.</li> </ul>
Excess frost and ice has built up inside the appliance.	<ul style="list-style-type: none"> <li>• Check that the door has not been left open.</li> <li>• Check that the door gasket is clean and undamaged.</li> </ul>

**Please note:** Any damage caused by not following the instructions within this handbook may lead to a charge for a service engineer visit and any repairs carried out.

## REVERSING THE DOOR

### Reversing the door

For the doors on the LC SRS149W

Warning: Remove the main plug before reversing the door. 2 people may be required to reverse the door.

1. Remove the screws (6) holding the top panel (7) to the unit. Remove the top panel.
2. Remove the two screws (1) holding the top hinge (5) (right side) to the frame. Remove the top hinge (5).
3. Lift the door off the bottom hinge pin and place it on a non-scratching surface.
4. Remove the two screws (8) holding the bottom hinge (2). Remove the bottom hinge (2).
5. Remove the left front feet (4) and transfer it to the right side.
6. Before replacing the bottom hinge (2), remove the hinge pin (9) and reverse the direction of the hinge (2). Reassemble the bottom hinge (2) on the left hand side using the two screws (8).
7. Refit the hinge pin (9) into the bottom hinge (2).
8. Lower the door onto the bottom hinge pin (9).
9. While holding the door in the closed position, reassemble the upper hinge (5) on the left hand side using the two screws (1). Do not tighten the screws (1) until the top of the upper door is level with the counter top.
10. Refit the top panel (7) using the screws (6)

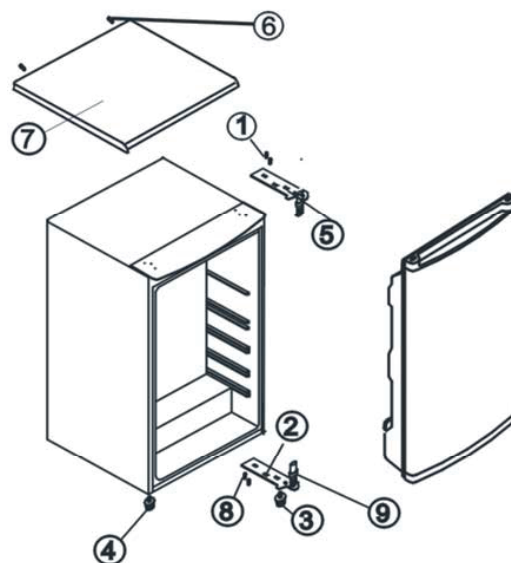

**FIGURE 1**

Door opening from left side

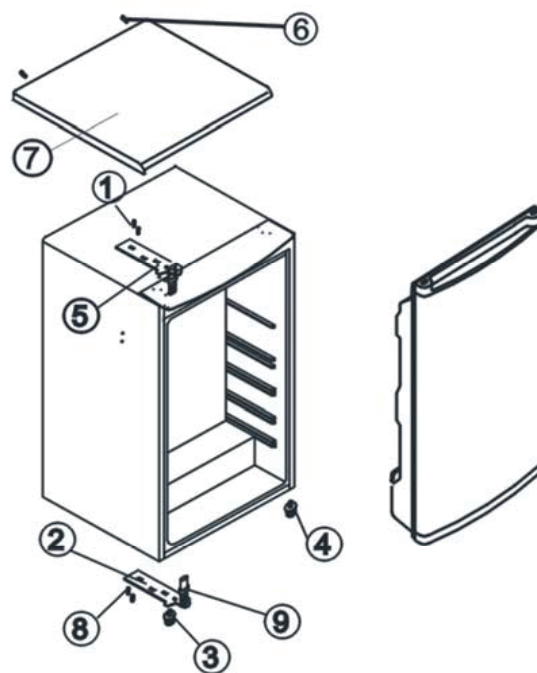

**FIGURE 2**

Door opening from right side

## REVERSING THE DOOR

For the doors on the LC SRS236W

**Note:** Please unplug the unit before action

1. Remove the right top hingercover.



2. Remove the screws fixed the top-hinge with cross-slot screwdriver.

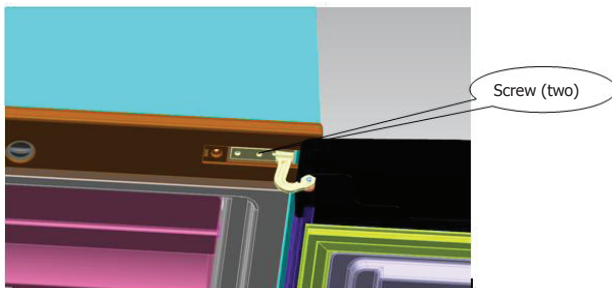

3. Replace the top-hinge and the top-door limit block and the door bearing bush to the other side. A) Remove the nut with sleeve. Take off the washer then remove the axes to the other side and fixed.

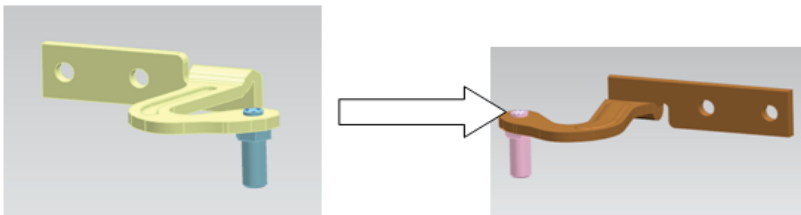

- B) Remove the door limit block

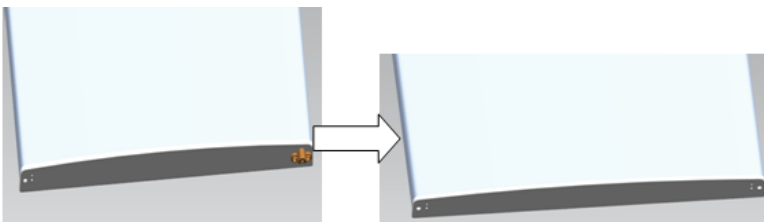

- C) Please taking out another door limit block, with screw mounting to the door



## REVERSING THE DOOR

4. Disassemble the screws fixed the bottom-hinge with cross-slot

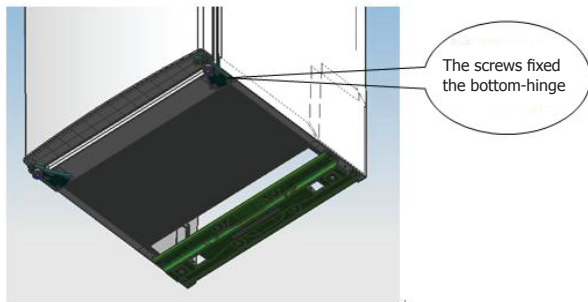

**Note:** The refrigerator-freezer incline angles less  $45^{\circ}$

5. Replace the bottom hinge to the other side then fix it with screws.

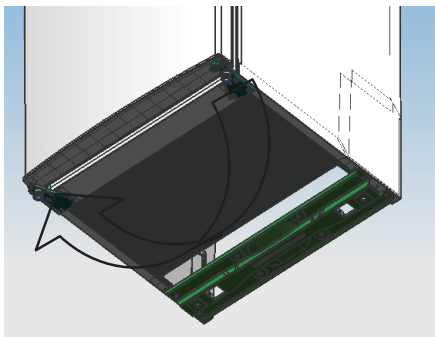

6. Set the door right position, fix the mid-hinge

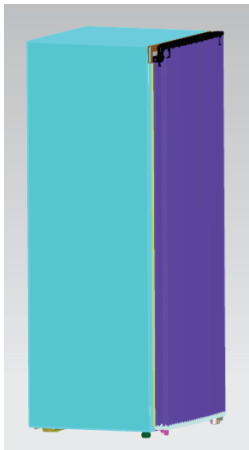

7. Replace the top-hinge.

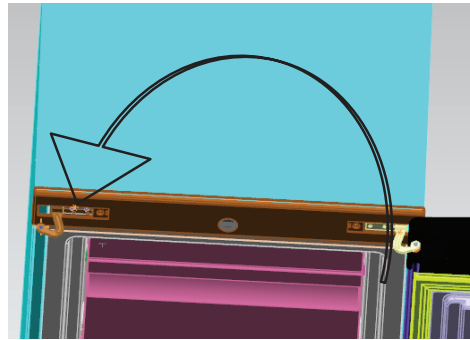

8. Set the top door right position, fix the top-hinge and the cover.



9. Replace the leveler to the other side and adjust it to make sure the cabinet level.

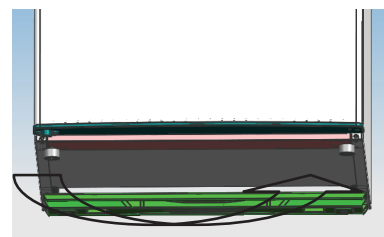



## REVERSING THE DOOR

For the doors on the LC SRS115W

1. Unscrew the top cover and take off it.



2 screws for  
fixing the top  
cover

2. Unscrew the top hinge.

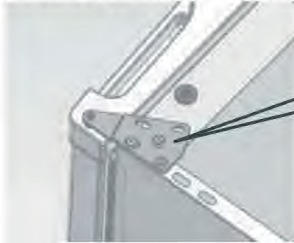

3 screws for  
fixing top  
hinge

3. Re-install the top hinge pin, shaft sheath and block piece on the opposite side. A: Move the top hinge to opposite side



B: Move the shaft sheath and block piece to opposite side also



4. Unscrew the three screws on the down hinge and screw them on the opposite side.

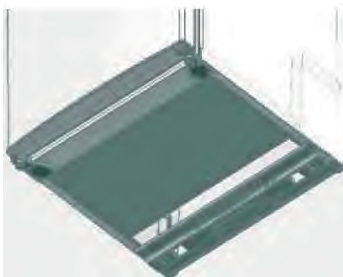

5. Move the adjustable foot to the opposite side.



6. Align the door properly, fix the top hinge and top cover.





## CHANGING THE PLUG

Any electrical work required to install this appliance should be carried out by a qualified electrician or competent person. This appliance must be earthed. The manufacturer declines any liability should these safety measures not be observed.

### Electrical Requirements

Before switching on, make sure the electricity supply voltage is the same as that indicated on the appliance rating plate. The appliance is supplied with a 13 amp plug fitted. In the event of having to change the fuse in the plug supplied, a 13 amp ASTA approved (BS 1362) fuse must be used. Should the plug need to be replaced for any reason. The wires in the mains lead are coloured in accordance with the following code:

Green and Yellow: Earth

Blue: Neutral

Brown: Live

The wire coloured green and yellow must be connected to the terminal marked with the letter "E" or by the earth symbol  $\equiv$  or coloured green and yellow. The wire coloured blue must be connected to the terminal marked "N". The wire coloured brown must be connected to the terminal marked "L".

Upon completion there must be no cut, or stray strands of wire present and the cord clamp must be secure over the outer sheath.

### Important!

The plug must still be accessible after the appliance has been installed. The appliance should not be connected to the electrical supply by means of an extension cable. In case that the electrical cable has to be replaced, please contact the Customer Care Centre and arrange a service engineers visit.

**WARNING:** A cut off plug inserted into a 13 amp socket is a serious safety (shock) hazard. Ensure that it is disposed of safely. This appliance complies with the following E.E.C Directives: 2006/95/EC (Low Voltage Directive) and subsequent modifications, 2004/108/EC (Electromagnetic Compatibility Directive) and subsequent modifications.

### LC SRS115W model

A cut off plug inserted into a 13 amp socket is a serious safety (shock) hazard. Ensure that it is disposed of safely. This appliance complies with the following E.E.C. Directives: 73/23 EEC of 19.02.73 (Low Voltage Directive) and subsequent modifications, 89/336 EEC of 03.05.89 (Electromagnetic Compatibility Directive) and subsequent modifications.

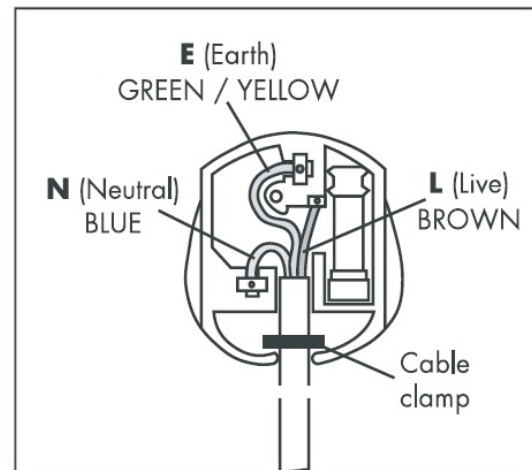

The wires in the mains lead are coloured in accordance with the following code:

Green and Yellow = Earth

Blue = Neutral

Brown = Live

**Note:** Figured in the user manual are only for reference. The actual product may differ slightly

## CUSTOMER CARE

Please record your model number and serial number in the space below. Having these numbers to hand will help us to help you, quickly and more efficiently.

When contacting us, please use the Customer Care number located in the bottom of this page.

<b>Model Number</b>	
<b>Serial Number</b>	

<b>Date of purchase</b>	<b>Installers stamp / print name</b>	<b>Date of installation</b>

<b>Purchased from</b>	
-----------------------	--

<b>Date</b>	<b>Part(s) replaced</b>	<b>Engineers stamp / printed name</b>

In the event of a problem, please call our Customer Care Centre  
on: 0344 815 3742



Glen Dimplex Professional Appliances,  
Stoney Lane, Prescott, Merseyside, L35 2XW

Customer Care Centre: 0344 815 3742  
[www.lec-commercial.co.uk](http://www.lec-commercial.co.uk)

Glen Dimplex Professional Appliances, a division of Glen  
Dimplex Home Appliances